

GAM Simulated Simsboro drawdown (feet) due to 40,835 ac-ft/yr Vista Ridge pumpage

Proposed PW-18 location

Existing Vista Ridge Simsboro well

POSGCD Registered / Permitted Simsboro well

Vista Ridge lease properties

Note: The contours shown on this plate were generated using the Central Carrizo-Wilcox-Queen City-Sparta Groundwater Availability Model (GAM). The hydraulic parameters assigned to the GAM in the Vista Ridge area are not consistent with pump test results recorded during construction and testing of Vista Ridge production wells and, consequently, the results shown are not accurate. Please see the Groundwater Modeling Technical Memorandum under Tab 4 for details.

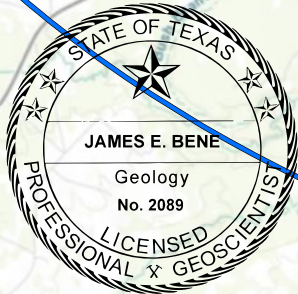
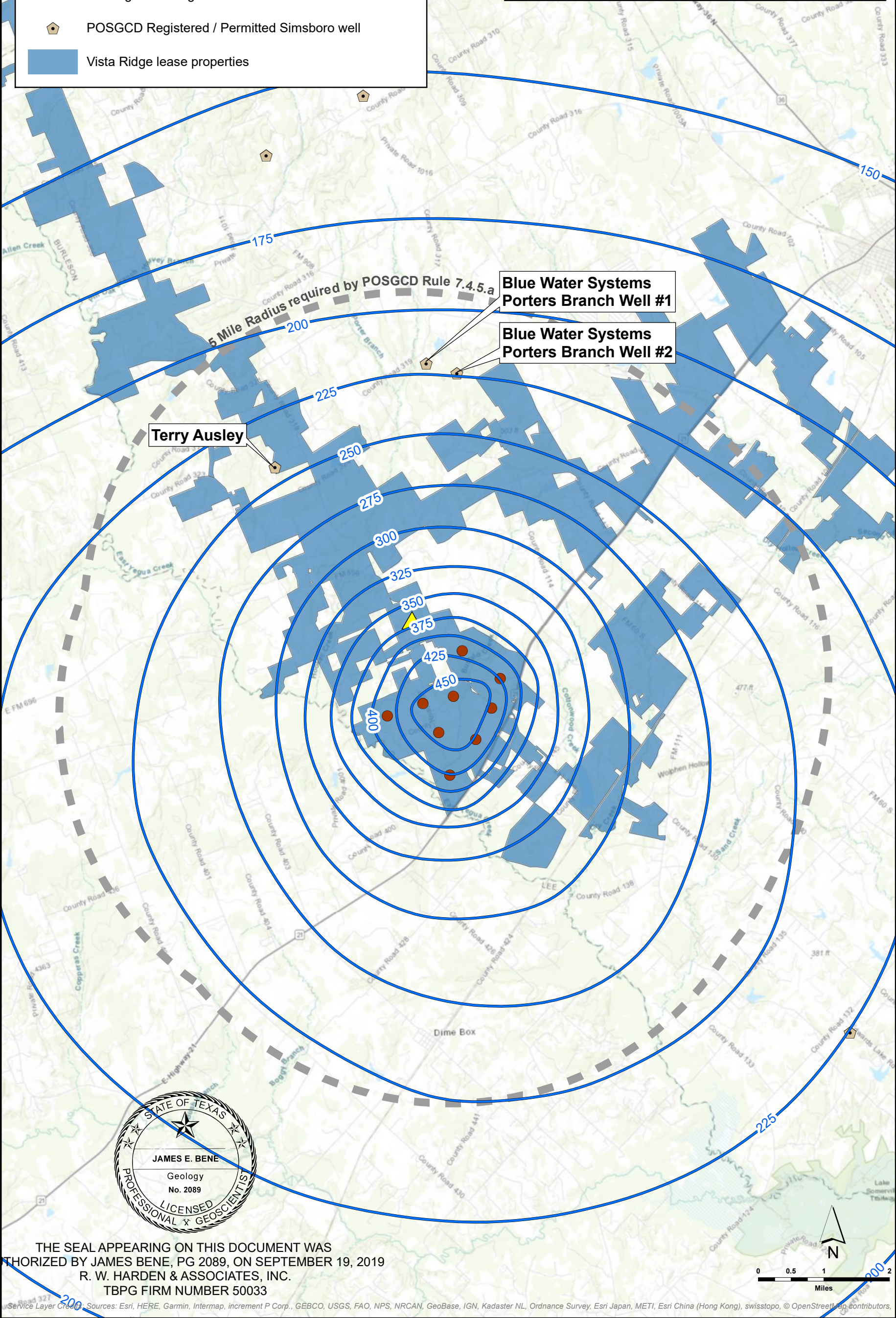

THE SEAL APPEARING ON THIS DOCUMENT WAS  
 AUTHORIZED BY JAMES BENE, PG 2089, ON SEPTEMBER 19, 2019  
 R. W. HARDEN & ASSOCIATES, INC.  
 TBPG FIRM NUMBER 50033

Service Layer Credits: Sources: Esri, HERE, Garmin, Intermap, increment P Corp., GEBCO, USGS, FAO, NPS, NRCAN, GeoBase, IGN, Kadaster NL, Ordnance Survey, Esri Japan, METI, Esri China (Hong Kong), swisstopo, © OpenStreetMap contributors,



Plate 14 - GAM Simulated Simsboro Drawdown due to Vista Ridge 40,835 ac-ft/yr (2020-2050)